

Single-door Refrigerator

REF-195-S



Online Warranty Registration



Please read these instructions and warranty information carefully before use and keep them handy for future reference.

## USER MANUAL

請即進行保用登記！  
有關保用條款細則，請看說明書最後一頁。

---

Please register your warranty information now !  
For Warranty Terms & Conditions,  
please refer to the last page of this user manual.

## Table of Contents

---

Warnings & Safety Precautions	04
Product Structure	08
Installation Instructions	09
Operation Instructions	13
Cleaning & Maintenance	15
Troubleshooting	17
Technical Specification	18
Warranty Terms & Conditions	31

# Warnings & Safety Precautions

## **⚠ WARNING!**

Read all instructions carefully before using this product.

- This product is for domestic indoor use only. If this product is used for any commercial, industrial, rental or other purposes, product warranty will be VOIDED.
- This product is not intended for use by children or persons with reduced physical, sensory or mental capabilities, or lack of experience and knowledge, unless they have been given supervision or instruction concerning use of this product by an adult responsible for their safety.
- Mind your children and DO NOT let children play with this product.
- Cleaning and user maintenance shall not be made by children without supervision.
- Check the voltage indicated on the rating label before using this product.
- If the supply cord is damaged, it must be replaced by the manufacturer, its service agent or similarly qualified persons in order to avoid hazards.
- Unplug this product from the power source before cleaning and maintenance.
- Contact German Pool authorized service technician for repair or maintenance of this product.

In the interest of your safety and to ensure the correct use, before installing and first using this product, read this user manual carefully, including its hints and warnings. To avoid unnecessary mistakes and accidents, it is important to ensure that all people using this product are thoroughly familiar with its operation and safety features. Save these instructions and make sure that they remain with this product if it is moved or sold, so that everyone using it through its life will be properly informed on product use and safety.

For the safety of life and property keep the precautions of these user's instructions as the manufacturer is not responsible for damages caused by omission.

## **Children And Vulnerable People Safety**

1. This product can be used by children aged from 8 years and above and persons with reduced physical, sensory or mental capabilities or lack of experience and knowledge if they have been given supervision or instruction concerning use of this product in a safe way and understand the hazards involved.
2. Children should be supervised to ensure that they DO NOT play with this product.
3. Cleaning shall not be made by children unless they are aged from 8 years and above and supervised.
4. Keep all packaging well away from children. There is risk of suffocation.
5. If you are discarding this product, pull the plug out of the socket, cut the connection cable (as close to the product as you can) and remove the door to prevent playing children to suffer electric shock or to close themselves into it.
6. If this product featuring magnetic door seals is to replace an older appliance having a spring lock (latch) on the door or lid, be sure to make that spring lock unusable before you discard the old appliance. This will prevent it from becoming a death trap for a child.

# Warnings & Safety Precautions

## **General Safety**

1. **⚠ WARNING!** Keep ventilation openings, in the product enclosure or in the built-in structure, clear of obstruction.
2. **⚠ WARNING!** DO NOT use mechanical devices or other means to accelerate the defrosting process, other than those recommended by the manufacturer.
3. **⚠ WARNING!** DO NOT damage the refrigerant circuit.
4. **⚠ WARNING!** DO NOT use other electrical appliances (such as ice cream makers) inside of refrigerating appliances, unless they are approved for this purpose by the manufacturer.
5. **⚠ WARNING!** DO NOT touch the light bulb if it has been on for a long period of time because it could be very hot.\*
6. DO NOT store explosive substances such as aerosol cans with a flammable propellant in this product.
7. The refrigerant isobutane (R600a) is contained within the refrigerant circuit of this product, a natural gas with a high level of environmental compatibility, which is nevertheless flammable.
8. During transportation and installation of this product, be certain that none of the components of the refrigerant circuit become damaged.
  - avoid open flames and sources of ignition.
  - thoroughly ventilate the room in which this product is situated.
9. It is dangerous to alter the specifications or modify this product in any way. Any damage to the cord may cause a short circuit, fire and/or electric shock.
10. This product is intended to be used in household and similar applications such as:
  - staff kitchen areas in shops, offices and other working environments;
  - farm houses and by clients in hotels, motels and other residential type environments;
  - bed and breakfast type environments;
  - catering and similar non-retail applications.
11. **⚠ WARNING!** Any electrical components (plug, power cord, compressor and etc.) must be replaced by a certified service agent or qualified service personnel.
12. **⚠ WARNING!** The light bulb supplied with this product is a "special use lamp bulb" usable only with the appliance supplied. This "special use lamp" is not usable for domestic lighting.\*
13. Power cord must not be lengthened.
14. Make sure that the power plug is not squashed or damaged by the back of this product. A squashed or damaged power plug may overheat and cause a fire.
15. Make sure that you can reach the mains plug of this product.
16. DO NOT pull the mains cable.
17. If the power plug socket is loose, DO NOT insert the power plug. There is a risk of electric shock or fire.
18. You must not operate this product without its lamp.
19. This product is heavy. Care should be taken when moving it.
20. DO NOT remove nor touch items from the freezer compartment if your hands are damp/wet, as this could cause skin abrasions or frost/freezer burns.
21. Avoid prolonged exposure of this product to direct sunlight.

# Warnings & Safety Precautions

\*If there is a light in the compartment.

## Daily Use

1. DO NOT put hot items on the plastic parts in this product.
2. DO NOT place food products directly against the rear wall.
3. Frozen food must not be re-frozen once it has been thawed out.^
4. Store pre-packed frozen food in accordance with the frozen food manufacturer's instructions.^
5. This product's manufacturer's storage recommendations should be strictly adhered to. Refer to relevant instructions.
6. DO NOT place carbonated or fizzy drinks in the freezer compartment as it creates pressure on the container, which may cause it to explode, resulting in damage to this product.^
7. Ice lollies can cause frost burns if consumed straight from this product.^

## Care and Cleaning

1. Before maintenance, switch off this product and disconnect the mains plug from the mains socket.
2. DO NOT clean this product with metal objects.
3. DO NOT use sharp objects to remove frost from this product. Use a plastic scraper.^
4. Regularly examine the drain in this product for defrosted water. If necessary, clean the drain. If the drain is blocked, water will collect in the bottom of this product.#

^If there is a freezer compartment.

#If there is a fresh-food storage compartment.

## Installation

 **WARNING!** For electrical connection carefully follow the instructions given in specific paragraphs.

1. Unpack this product and check if there are damages on it. DO NOT connect this product if it is damaged. Report possible damages immediately to the place you bought it. In that case retain packing.
2. It is advisable to wait at least four hours before connecting this product to allow the oil to flow back in the compressor.
3. Adequate air circulation should be around this product, lacking this leads to overheating. To achieve sufficient ventilation, follow the instructions relevant to installation.
4. Wherever possible the spacers of this product should be against a wall to avoid touching or catching warm parts (compressor, condenser) to prevent possible burn.
5. This product must not be located close to radiators or cookers.
6. Make sure that the mains plug is accessible after the installation of this product.

# Warnings & Safety Precautions

## Service

1. Any electrical work required to do the servicing of this product should be carried out by a qualified electrician or competent person.
2. This product must be serviced by an authorized Service Center, and only genuine spare parts must be used.

## Energy Saving

1. DO NOT put hot food in this product.
2. DO NOT pack food close together as this prevents air circulating.
3. Make sure food DO NOT touch the back of the compartment(s).
4. If electricity goes off, DO NOT open the door(s).
5. DO NOT open the door(s) frequently.
6. DO NOT keep the door(s) open for too long time.
7. DO NOT set the thermostat on exceedingly cold temperatures.
8. Some accessories, such as drawers, can be removed to get larger storage volume and lower energy consumption.

## Environment Protection

This product does not contain gasses which could damage the ozone layer, in either its refrigerant circuit or insulation materials. This product shall not be discarded together with the urban refuse and rubbish. The insulation foam contains flammable gases: this product shall be disposed according to the appliance regulations to obtain from your local authorities. Avoid damaging the cooling unit, especially the heat exchanger. The materials used on this product marked by the symbol  are recyclable.



The symbol on the product or on its packaging indicates that this product may not be treated as household waste. Instead, it should be taken to the appropriate collection point for the recycling of electrical and electronic equipment. By ensuring this product is disposed of correctly, you will help prevent potential negative consequences for the environment and human health, which could otherwise be caused by inappropriate waste handling of this product. For more detailed information about recycling of this product, please contact your local council, your household waste disposal service or the shop where you purchased this product.

## Packaging Materials

The materials with the symbol  are recyclable. Dispose the packaging in a suitable collection container to recycle it.

## Disposal Of This Product

1. Disconnect the mains plug from the mains socket.
2. Cut off the mains cable and discard it.

# Product Structure

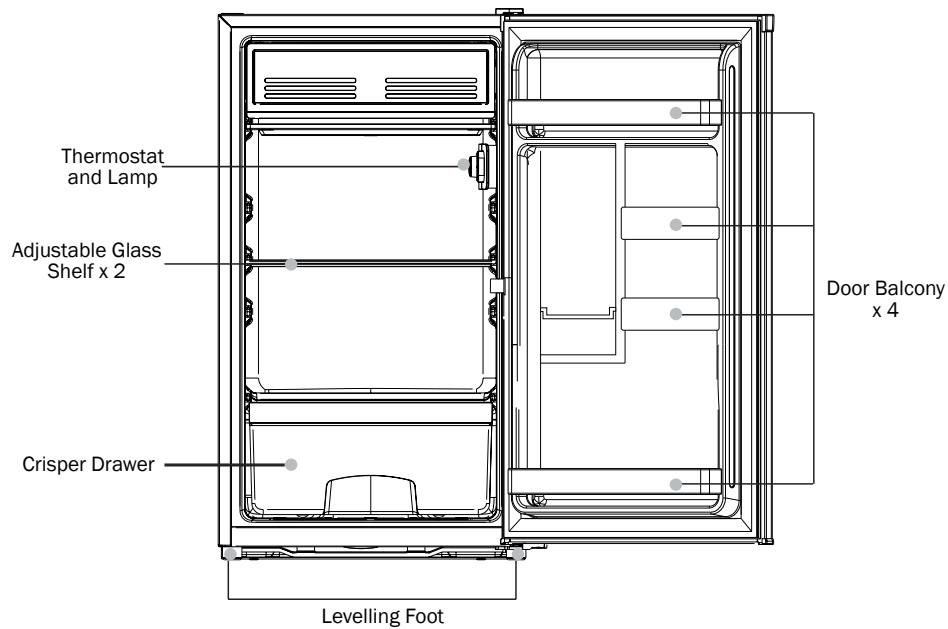

# Installation Instructions

## Reversing the Door Opening Direction (Optional)

User can skip this part if the refrigerator door is opening in the direction you want. Otherwise, reverse the position of the hinges. To do this, carefully place the refrigerator on its back. Use spacers to prevent crushing the condenser pipes and damaging the compressor unit.

Tool required: Philips screwdriver, flat head screwdriver, hexagonal spanner.

### Note:

- Make sure the product is unplugged and empty.
- To take the door off, it is necessary to tilt the refrigerator backwards. You should rest the refrigerator on something solid so that it will not slip during the door-reversing process.
- All parts removed must be saved for reinstalling the door.
- Do not lay the refrigerator flat as this may damage the coolant system.
- It is recommended better that 2 persons handle the refrigerator during assembly.

1. Remove the top right hinge cover.

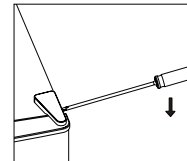

2. Undo the screws, then remove the hinge bracket.

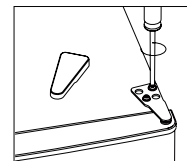

3. Remove the top left screw cover.

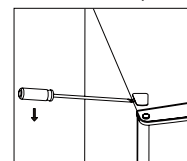

4. Move the core cover from left side to right side. Lift and remove the door and place it on a padded surface to prevent it from getting scratched.

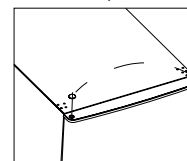

# Installation Instructions

5. Unscrew bottom hinge. Then remove the adjustable foot from the other side.

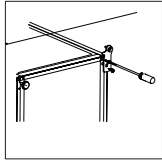

6. Unscrew and remove the bottom hinge pin with flat head screwdriver, flip the bracket over to the other side and reinsert the pin.

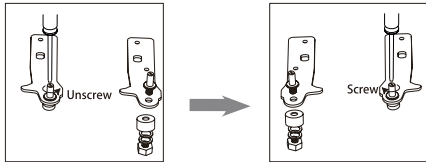

7. Refit the bracket to align the bottom hinge pin. Reinstall the levelling foot.

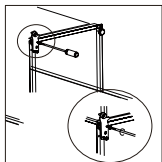

8. Place the door back on. Ensure the door is aligned both horizontally and vertically so that the seals can close properly on all sides before finally tightening the top hinge.

9. Insert the hinge bracket and screw it to the top of the refrigerator.

10. Use a spanner to tighten it if necessary.

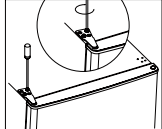

11. Put the hinge cover and the screw cover back.

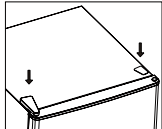

12. Peel off the magnetic door seal, rotate 180° and reinstall.

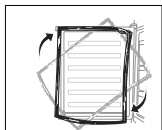

# Installation Instructions

## Space Requirement

- Make sure to leave enough space to ensure the refrigerator door can open completely.
- Leave at least 50mm free space on both sides of the refrigerator.

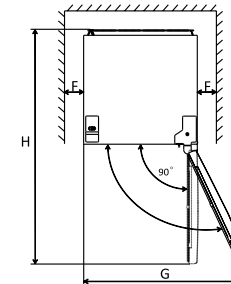
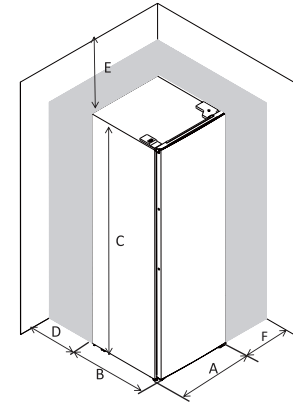

A	475
B	445
C	850
D	min=50
E	min=50
F	min=50
G	785
H	848.5

(in mm)

## Levelling The Unit

- Adjust the two levelling feet to make sure the refrigerator is level and not slanted.
- If the refrigerator is not level, the magnetic door seal and refrigerator door will not close properly.

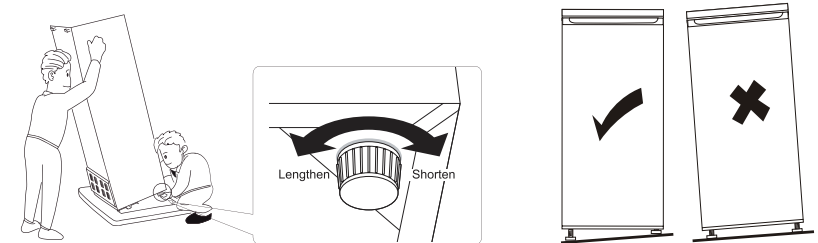

## Positioning Of Unit

This refrigerator should be installed away from heat sources such as radiators, boilers, direct sunlight, etc., and positioned in a location where air can circulate freely around all sides of the product. To ensure best performance, if this refrigerator is positioned below an overhanging appliance/cabinet, make sure to keep at least 50mm space between the top of this refrigerator and the appliance/cabinet. Ideally, it is recommended not to position this refrigerator beneath any appliance/cabinet. Use the adjustable feet to make sure this refrigerator stands levelled.

# Installation Instructions

## ⚠ WARNING!

- This refrigerator is not intended to be used as a built-in appliance.
- Make sure the power plug is easily accessible after the refrigerator is installed, in case the power source needs to be disconnected should occasion arise.

## Electrical Connection

- Before plugging in, make sure the voltage and frequency shown on the rating label correspond to your domestic power supply. This product must be properly earthed. If your domestic power supply socket is not earthed, consult a qualified electrician to connect this product to a separately earthed socket.
- The manufacturer declines all responsibility and liability if the above safety precautions are not observed.
- This appliance complies with the E.E.C. Directives.

# Operation Instructions

## Upon Initial Use

### Cleaning The Interior

Before using this refrigerator for the first time, wash the interior and all internal accessories with lukewarm water and neutral soap so as to remove any dirt and new product smell, then wipe dry thoroughly.

## ⚠ WARNING!

DO NOT use or abrasive detergents or cleansers, as these will damage the product's finish.

## Temperature Setting

- When plugged into the power source, the internal temperature of this refrigerator will be controlled by a thermostat. There are 8 settings. 1 is warmest setting and 7 is coldest setting, and 0 is to turn off the refrigerating system.
- This refrigerator may not operate at the correct temperature if the environment is particularly hot or if the refrigerator door is left open.

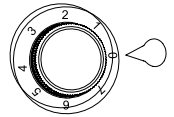

## Adjustable Shelves

The shelves can be freely moved among different height levels.

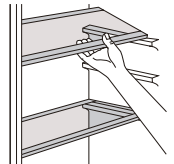

## Positioning The Door Balconies

The two small door balconies can be placed at different heights to accommodate for different foods or beverages. Follow the steps below to adjust the balconies:

1. Pull out the balcony.
2. Select the height you want, then press the balcony down until it is securely installed.

## Crisper Drawer

The crisper drawer is suitable for storing fruit and vegetables. It can be pulled out freely.

## Thawing

- Frozen food can be thawed in a fridge compartment or at room temperature prior to cooking. Place frozen food in a dish or bowl to avoid melted condensation dripping onto the refrigerator.
- This refrigerator is not suitable for freezing food.

# Operation Instructions

---

## Hints For Fresh Food Refrigeration

- DO NOT store warm food or evaporating liquids in the refrigerator.
- Cover or wrap the food, particularly if it has a strong flavor.
- Position food so that air can circulate freely around it.

## Hints For refrigeration

- Meat (all types): wrap in polythene bags and place on the glass shelf above the crisper drawer. It is recommended to store in this way only one or two days at the most.
- Cooked foods, cold dishes, etc.: these should be covered and may be placed on any shelf.
- Fruits and vegetables: these should be thoroughly cleaned and placed in the crisper drawer.
- Butter and cheese: these should be placed in airtight containers, polythene bags or wrapped in aluminum foil to exclude as much air as possible.
- Milk bottles: these should be capped and stored on the door balconies.
- Bananas, potatoes, onions and garlic, if not packed, must not be kept in the refrigerator.

# Cleaning & Maintenance

---

For hygienic reasons the refrigerator interior, including interior accessories, should be cleaned regularly.

## **WARNING!**

- Power **MUST** be disconnected before cleaning. Danger of electric shock!
- Before cleaning, unplug this refrigerator from the power socket or switch off the circuit breaker/fuse.
- DO NOT clean this refrigerator with a steam cleaner, as moisture could accumulate in the electrical components. Danger of electric shock! Hot vapors can lead to the damage of plastic parts.
- The refrigerator must be dry before it is placed back into service.
- DO NOT allow ethereal oils, organic solvents (such as juice from lemon or orange peel), butyric acid or cleanser containing acetic acid to come into contact with this refrigerator as these substances can attack the plastic parts.
- DO NOT use any abrasive cleaners.

1. Remove food from the refrigerator. Store them in a cool place, well covered.
2. Clean the refrigerator and the interior accessories with soft cloth and lukewarm water. After cleaning, wipe with moist cloth and towel dry.
3. Accumulation of dust at the condenser increases energy consumption. For this reason carefully clean the condenser at the back of the refrigerator once a year with a soft brush or vacuum cleaner.\*
4. After everything is dry, place refrigerator back into service.

\*If the condenser is at back of refrigerator.



# Cleaning & Maintenance

## Replacing The Lamp

### ⚠ WARNING!

Disconnect the refrigerator from the mains power supply before replacing the lamp.

Follow below process to replace the lamp:

1. Set the temperature regulation knob at number "0" to turn off the refrigerating system.
2. Unplug the refrigerator to make sure it is disconnected from main power supply.
3. Remove the screw of the lamp cover.
4. Pull the lamp cover out.
5. Unscrew the bulb.
6. Screw in a new bulb, then replace the lamp cover and screw.
7. Plug in the refrigerator and regulate the knob to desired coldness.

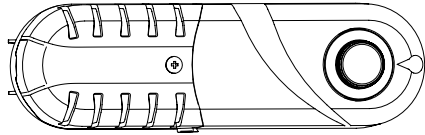

## Defrosting

- With time, the evaporator will become progressively covered with frost. Frost should be regularly be removed.
- DO NOT use sharp metal tools to scrape off frost from the evaporator as you could damage it.
- However, when the ice becomes very thick on the evaporator, complete defrosting should be carried out as follows:
  1. pull out the plug from the socket.
  2. Remove all stored food, wrap them in several layers of newspaper and put it in a cool place.
  3. Keep the refrigerator door open, and place a basin underneath the refrigerator to collect the defrost water.
  4. When defrosting is completed, dry the interior thoroughly.
  5. Re-plug the refrigerator to the power socket.

# Troubleshooting

### ⚠ WARNING!

Before troubleshooting, disconnect the power supply. Only a qualified electrician of competent person must do the troubleshooting that is not in this manual.

### Note:

The refrigerator will emit some sounds during when operating (compressor, refrigerant circulation). This is a normal phenomenon.

Problem	Possible Cause	Solution
Refrigerator does not work	Temperature regulation knob is set to "0"	Set the knob to desired coldness level to turn on the refrigerating system
	Power plug is not plugged in or is loose	Insert power plug properly
	Fuse has blown or is defective	Check fuse, replace if necessary
	Socket is defective	Mains malfunctions are to be corrected by an electrician
The food is not cold enough	Temperature is not properly adjusted	Please refer to "Temperature Setting" section
	Refrigerator door was open for an extended period	Open the door only as long as necessary
	The refrigerator is near a heat source	Please refer to "Positioning Of Unit" section
	A large quantity of warm food was placed in the refrigerator within the last 24 hours	Turn the temperature regulation knob to a colder setting temporarily
Refrigerator is too cold	Temperature is set too cold	Turn the temperature regulation knob to a warmer setting temporarily
Unusual noises	Refrigerator is not level	Re-adjust levelling feet
	Refrigerator is touching the wall or other objects	Move the refrigerator slightly
	A component (eg. pipe on the rear of the refrigerator) is touching another part of the refrigerator or the wall	If necessary, carefully reposition the component out of the way

### ⚠ WARNING!

If problem cannot be rectified, please contact Customer Service & Repair Centre for assistance. It is strictly forbidden to disassemble this product unless by a qualified professional technician.

## Technical Specification

---

<b>Model</b>	<b>REF-195-S</b>
Power	90 W
Voltage / Frequency	220-240 V ~ 50 Hz
Lamp	1 W
Refrigerant	R600a (26 g)
Rated Gross Capacity	92 L
Net Capacity	90 L
Product Dimensions	(H) 850 (W) 475 (D) 445 mm
Net Weight	19.5 kg

- Specification is subject to change without prior notice.
- If there is any inconsistency or ambiguity between the English version and the Chinese version, the English version shall prevail.
- Refer to [www.germanpool.com](http://www.germanpool.com) for the most update version of the user manual.

## 目錄

---

警告及注意事項	20
產品結構	23
安裝說明	24
使用說明	27
清潔及保養	28
故障檢修	30
技術規格	30
保用條款	31

## 警告及注意事項

### ⚠ 警告！

使用本產品前，請仔細閱讀所有說明。

- 本產品只限家居室內日常使用，如產品作任何商業、工業、出租或其他用途，保用證即告失效。
- 請勿讓兒童或身體有殘障、精神不健全及對本產品缺乏經驗或知識的人士單獨使用本產品；如需使用，必須要在負責任的成年人監管下方可使用。
- 應照顧好兒童，確保他們不會玩耍本產品。
- 無成年人監管下，勿讓兒童清潔及維護本產品。
- 使用前，請先檢查所有電壓是否與本產品標籤上的電壓相符。
- 如果電源線損壞，為免發生意外，電源線必須由廠方、廠方指定的維修中心或同等合格的技術人員進行更換。
- 清潔或檢查本產品前，必須先關機及拔掉插頭。
- 請聯繫德國寶授權的技術人員進行維修或保養本產品。

為確保正確使用和您的安全，安裝及初次使用前請仔細閱讀本說明書及其注意事項。為避免不必要的錯誤和事故，請確保操作使用本產品的人完全了解其操作和安全事項。請妥善保存本說明書，並確保其在轉移或轉售時順利傳至下任使用者手中，從而確保正確、安全使用。為保人身及財產安全，請確保緊跟本說明書所述之注意事項，因錯誤/疏忽操作所引起的損害，本公司概不承擔。

為保人身及財產安全，請確保緊跟本說明書所述之注意事項，因錯誤/疏忽操作所引起的損害，本公司概不承擔。

### 兒童和弱勢群體安全

1. 本產品可由8歲及以上年齡的兒童以及肢體不健全、感覺或精神上有障礙或缺乏相關經驗和知識的人士使用，但前提是有人對他們使用本產品進行監督或指導，以確保他們安全使用，並讓他們明白相關危害。
2. 兒童必須受到監督，以防擅自玩耍本產品。
3. 清潔工作嚴禁由兒童進行，除非他們年滿8歲並受到監督和指導。
4. 嚴禁讓兒童接觸包裝材料，以防窒息危險。
5. 棄置本產品時，必須拔除電源並剪斷電源線（盡可能近機身），然後拆下雪櫃門，以防兒童玩耍觸電或將自己關在機內造成危險。
6. 本產品採用磁力密封門技術，如以本產品替換舊式彈簧門雪櫃，必須在遺棄舊機前損毀彈簧鎖，以防對兒童造成危險。

### 一般安全事項

1. ⚠ 警告！保持設於雪櫃周圍或嵌入式架構內的通風口暢順，嚴禁遮蔽通風口。
2. ⚠ 警告！嚴禁使用製造商建議以外的方法，如機械裝置或其他途徑進行除霜作業。
3. ⚠ 警告！嚴禁損壞製冷劑回路。
4. ⚠ 警告！嚴禁勿於雪櫃內使用其他電器產品（如雪糕機），除非得到製造商證明許可。
5. ⚠ 警告！嚴禁用手觸摸燈膽，因照明燈長亮會發熱燙手。\*
6. 嚴禁在本產品中存放易爆物品，例如裝有易燃推進劑的氣霧罐。
7. 雪種 (R600a) 保存在雪櫃的製冷劑回路，這是一種環保但可燃的氣體。

## 警告及注意事項

8. 在本產品的運輸和安裝過程中，確保製冷劑回路的任何部件都沒有損壞。
  - 避免接觸易燃物或火源
  - 確保雪櫃安裝處充分通風
9. 任何形式的改裝都是危險的。電源線的損毀會造成短路、火災或觸電危險。
10. 本產品僅供家用或類似用途，如：
  - 商店、辦公室和其他工作環境中的員工廚房；
  - 農場、酒店、汽車旅館和其他居住環境；
  - 家庭旅館型環境；
  - 餐飲及類似的非營業性場合。
11. ⚠ 警告！任何電氣部件（插頭、電源線、壓縮機等）必須由授權服務機構或符合資格的專業電工進行更換。
12. ⚠ 警告！跟機的照明燈膽為專用燈膽，本機只可使用跟機燈膽。跟機照明燈膽不可用於家居照明。\*
13. 電源線嚴禁加長。
14. 確保電源插頭不受到擠壓或損毀。受到擠壓或損毀的電源插頭會過熱並引起火災危險。
15. 確保您可以接觸到本產品的電源插頭。
16. 嚴禁拉扯電源線。
17. 如果電源插頭或插座鬆動，嚴禁插入電源插頭，有觸電或火災的危險。
18. 嚴禁在於無照明的情況下使用本機。。
19. 本產品很重，搬運時必須小心。
20. 嚴禁用濕手拿去或接觸冷凍室內的物品，以防造成皮膚損傷或凍傷。
21. 嚴禁將本產品長時間暴露在陽光下直射。

\*如產品內附有燈

### 日常使用

1. 嚴禁將熱的物品放置在雪櫃的塑膠部件上。
2. 嚴禁將食物直接接觸後壁擺放。
3. 冷凍食品解凍後不可再次冷凍。^
4. 必須依照冷凍食品製造商的儲藏指引妥善保存冷凍食品。^
5. 必須嚴格遵守製造商的儲存建議，參考有關指引。
6. 嚴禁將含二氧化碳的氣泡飲品放入冷凍室，以防受壓爆炸，造成危險和損壞^
7. 如直接從雪櫃拿出雪條食用可能會造成凍傷。^

### 清潔及保養

1. 清潔前，必須關閉本產品並從電源插座上拔下電源插頭。
2. 嚴禁使用金屬物品清潔本產品。
3. 嚴禁使用尖銳物品進行除霜作業，請使用塑料刮刀。^
4. 定期檢查雪櫃除霜排水口。如有必要，請清理排水口，若排水口阻塞，融水將於機身底部排出。#

^如本產品配備急凍室。

#如本產品配備蔬果儲藏盒。

## 警告及注意事項

### 安裝

⚠ **警告！**對於電氣連接，必須遵循本說明書中的指引。

1. 拆下包裝檢查產品是否受損。如有損壞嚴禁使用，請立即聯絡銷售商報備損壞情況，並保存好包裝物料。
2. 接通電源前，建議等至少4小時後再使用，讓機油留回壓縮機，確保正常運行。
3. 機身附近應確保有充足的空氣流通，否則會引起過熱。必須參照安裝指引的要求以確保有效通風。
4. 機身的墊片必須貼牆面，避免發熱部件（壓縮機、冷凝器）直接接觸牆壁，以防燒毀。
5. 嚴禁將產品安裝在散熱裝置或煮食爐具附近。
6. 必須確保安裝後也能輕鬆接觸到產品的電源插頭。

### 售後服務

1. 維修本產品所需的任何電氣工作必須由合格的電工或合格人員進行。
2. 本產品的維修保用只可由授權的客戶服務及維修中心進行，且只能使用製造商提供的部件。

### 節能貼士

1. 嚴禁將熱的食物放入本產品中。
2. 嚴禁將食物緊貼地放在一起，因為這會阻礙空氣流通。
3. 確保食物不接觸隔間的背面。
4. 如遇停電，嚴禁打開本產品的門。
5. 嚴禁頻繁打開雪櫃門。
6. 嚴禁讓讓雪櫃門長時間打開。
7. 避免將溫度調至過低。
8. 抽屜等部分配件可拆卸，以增加儲物空間並降低能耗。

### 環境保護

本產品無論是製冷系統還是隔熱材料都不含會損害臭氧層的氣體。禁止將本產品作為生活垃圾處理。隔熱材料還有可燃氣體，處理本產品時應遵循到底有關規定。避免損壞製冷系統，特別是熱交換器。印有♻標記的物料是可循環物料。



產品或包裝上如印有此標記，表示該產品不可作為生活垃圾處理。相反，應將本產品送至合適的電氣和電子設備回收點。此產品的正確處理，有助於防止由於不正確處理產品而帶來的對環境、人體健康的危害。有關回收本產品的更多詳細資訊，請諮詢地方行業機構、生活垃圾回收服務點或購買該產品的商店。

### 包裝材料

帶有♻符號的包裝材料是可回收的，請將包裝物放入合適的收集容器中進行回收。

### 棄置本產品

1. 斷開產品電源。
2. 剪斷並棄置電源插頭。

## 產品結構

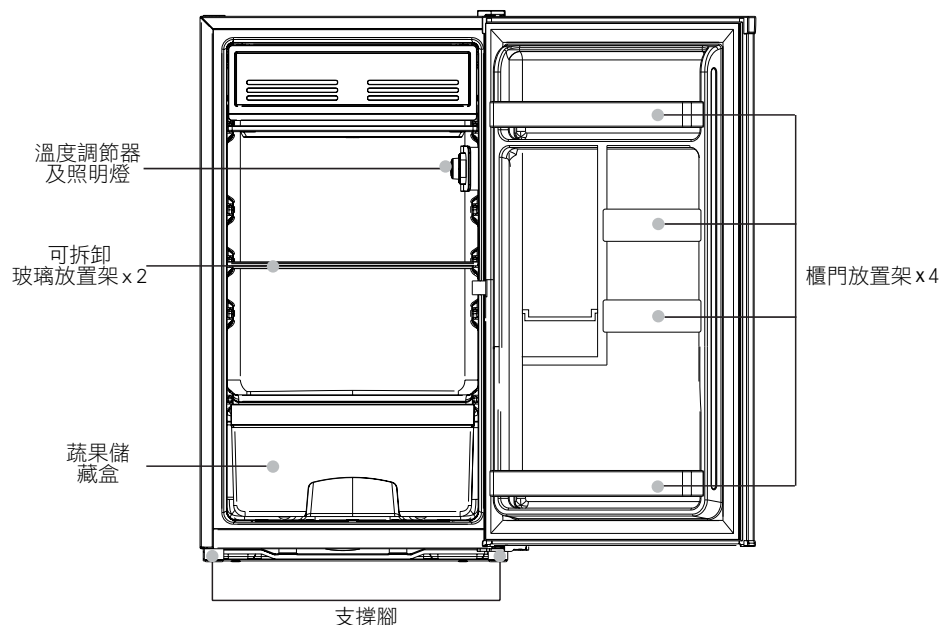

# 安裝說明

## 重置開門方向

如雪櫃開門方向符合您的要求，請略過此點。否則，把鉸鏈安裝在相反的方向。反轉開門方向時，請平放雪櫃。為防止壓碎冷凝管或損壞壓縮機，請使用墊片。

所需工具：十字螺絲刀、一字螺絲刀、六角扳手。

### 注意：

- 安裝前確保電源斷開，雪櫃內沒有任何物品。
- 要卸下雪櫃門，須將機身後翹起。請確保支撐物堅固穩定，以防作業過程中雪櫃滑倒。
- 請妥善保存所有卸下的部件，以備組裝。
- 請勿將雪櫃橫向放置以免損壞製冷系統。
- 組裝工作建議由兩人配合操作。

1. 卸下右上角的鉸鏈罩。

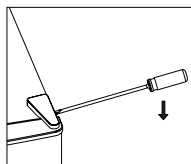

2. 卸下螺絲，拆下鉸鏈架。

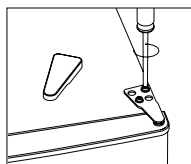

3. 取下左上角的螺絲蓋。

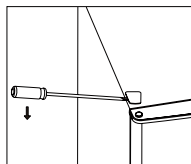

4. 將固定栓由左邊移至右邊。向上提起取下雪櫃門，並妥善放置好以防刮傷。

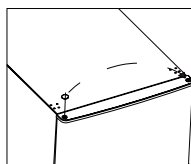

# 安裝說明

5. 卸下底部鉸鏈，從另一側移除支撐腳。

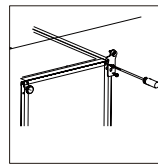

6. 用一字螺絲刀卸下底部鉸鏈栓，反轉鉸鏈架，再裝回鉸鏈栓。

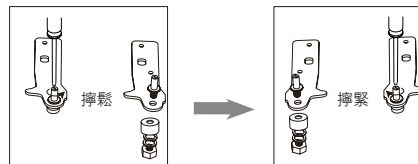

7. 調整鉸鏈架以對齊底部鉸鏈栓。裝回支撐腳。

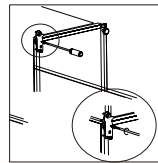

8. 裝回雪櫃門，並確保在最後擰緊上鉸鏈前，雪櫃門水平和垂直都對齊，且關閉時各個方向都能密封。

9. 插入鉸鏈架並擰緊螺絲。

10. 如有必要可用扳手加固擰緊。

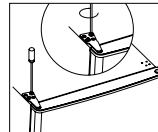

11. 裝回鉸鏈罩並固定好。

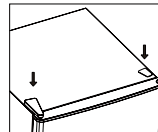

12. 拆下磁性密封條，旋轉180°再裝上。

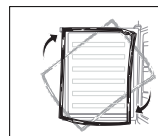

# 安裝說明

## 安裝空間要求

- 留有足夠空間讓門可無阻開關。
- 機身兩邊保留至少50mm間隙。

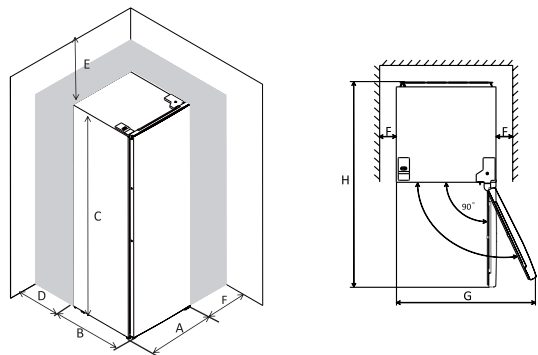

A	475
B	445
C	850
D	最少=50
E	最少=50
F	最少=50
G	785
H	848.5

(單位:毫米)

## 放置機身

- 調整支撐腳高度以保持機身放置水平。
- 若雪櫃未能水平放置，將影響門和磁力密封系統，導致雪櫃門無法正確關閉。



## 安裝位置

本產品應避免安裝在散熱器、鍋爐等熱源附近，避免陽光直射，並確保機身四周空氣流通。如本產品安裝在掛牆電器或吊櫃的下方，為獲得最佳運作效果，請確保掛牆電器或吊櫃與雪櫃頂部的距離不少於50mm。如環境許可，建議不要將本產品安裝在其他掛牆電器下方。請妥善使用支撐腳以保持機身水平放置。

## ⚠ 警告！

- 本產品不可用作嵌入式。
- 必須確保安裝後電源插頭也能被輕鬆接觸到，以便斷開電源連接。

## 電氣連接

- 接通電源前，必須確保家中電力供應與銘牌上所示的電壓和頻率相一致。本產品必須妥善接地。如家中電源插座未接地，必須求助符合資格的專業電工，將本產品接入已妥善接地的獨立電源中。
- 如因違反本說明書的注意事項而引起危險和損失，本公司概不負責。
- 本機符合E. E. C. 指令。

# 使用說明

## 初次使用

### 清潔雪櫃內部

初次使用前，請用溫水及中性清潔劑清洗雪櫃內部及配件，以清除污漬和異味，然後徹底擦乾。

## ⚠ 警告！

嚴禁使用有腐蝕或磨損性的清潔劑，以免對雪櫃造成損害。

## 溫度設定

- 通電後，雪櫃內的溫度將由溫度調節器進行控制。共設有8檔溫度，1檔溫度最高，7檔溫度最低，0檔表示關閉製冷功能。
- 溫度過高或雪櫃門打開時，雪櫃溫度或有偏差。

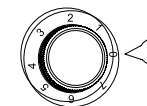

## 可拆卸放置架

可自由移動放置架，調整至合適位置。

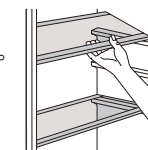

## 調整櫃門放置架

兩個較小型的櫃門放置架的位置可自由調節，以適應不同體積的食品和飲料。請參考以下步驟：

1. 拉出櫃門放置架。
2. 選擇合適的位置，推入放置架，直至完全鎖緊。

## 蔬果儲存盒

適合冷藏儲存蔬菜和水果，輕鬆一拉即可取出。

## 解凍

- 使用冷凍食品前可於雪櫃內特定區域或室溫下進行解凍。將冷凍食品放置在碟或碗中，以防融化的冰水溢出。
- 本產品不適用於急凍食品。

## 新鮮食品冷藏貼士

- 請勿將溫熱的食品或會蒸發的液體直接放入雪櫃內。
- 請將食品覆蓋或包裹好再放入雪櫃，特別是味道較重的食品。
- 放置食品時請確保食品四周通風良好。

## 冷藏貼士

- 肉類（所有種類）：裝入保鮮袋並放在可拆式放置架上，建議只保存1-2天。
- 熟食、冷盤等：需覆蓋或包裹好，可放在任何層架上。
- 水果和蔬菜：徹底洗淨後放置在蔬果儲存盒內。
- 牛油和芝士：應放入真空密封容器、保鮮袋或用錫箔紙或包裹好，盡量避免接觸空氣。
- 牛奶樽：請蓋好蓋子，並放置在雪櫃門後的放置架上。
- 香蕉、薯仔、洋蔥和大蒜等，如未包裝好，切勿放入雪櫃。

# 清潔與保養

為確保使用衛生，雪櫃內部包括配件在內需定期清潔。

## ⚠ 警告！

- 清潔前請確保斷開電源，以免發生觸電危險！
- 清潔前必須拔下雪櫃的電源插頭或關掉菲士接線蘇。
- 嚴禁用蒸氣噴霧型清潔用品清洗本機，因蒸氣會損壞精密電子部件，造成觸電危險！熱蒸氣會對塑膠部件造成損害。
- 再次通電前必須先擦乾雪櫃。
- 精油和有機溶劑如檸檬汁、橙皮中的汁液、丁酸，或酸性的清潔劑，會對塑膠部件造成損害。嚴禁讓上述類似物質接觸本產品。
- 嚴禁使用研磨性清潔劑。

1. 從雪櫃取出食物，放置在清涼的地方，並覆蓋好。
2. 用沾有溫水的濕布清潔雪櫃機器內部配件，之後用沾有清水的軟布再擦拭一次，並擦乾。
3. 冷凝器積塵會增加運作能耗。請使用軟刷或吸塵機每年定期清理雪櫃背部的冷凝器。\*
4. 雪櫃重新投入使用前，確保其已經擦乾晾乾。

\*如冷凝器在本產品機身後部

# 清潔與保養

## 更換照明燈

## ⚠ 警告！

更換照明燈前，請先關閉雪櫃，拔下電源插座。

請依照下述步驟更換燈膽：

1. 將溫度調節器轉至“0”，關閉雪櫃。
2. 拔下電源插頭以確保本產品已與主電源斷開連接。
3. 拆下燈罩上的螺絲。
4. 拆下燈罩。
5. 取下燈膽。
6. 換上新的燈膽，反向旋轉直至燈膽擰緊固定好，再裝上燈罩及擰上螺絲。
7. 插上電源插頭，旋轉溫度調節器至合適的檔位。

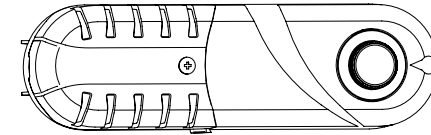

## 除霜

- 隨著使用時間的增加，雪櫃的蒸發器將日益被冰霜覆蓋，需進行除霜作業。
  - 嚴禁使用尖銳的工具進行除霜，以防造成損害。
  - 當霜凍現象嚴重，冰層較厚時，可按如下步驟進行徹底除霜：
1. 拔下電源插頭。
  2. 取出雪櫃中所有食品，用報紙包裹好，並存放在清涼的地方。
  3. 保持雪櫃門打開，於雪櫃底部放置接水盆接住融化的冰水。
  4. 除霜完成後，徹底擦乾雪櫃內部。
  5. 插上電源插頭，重新開始運作。

## 故障檢修

### ⚠ 警告！

維修前必須確保電源斷開。只有符合資格的專業電工才能進行說明書所述以外的故障排查工作。

### 注意：

雪櫃在使用過程中會有微弱聲響（壓縮機、循環裝置運作噪音），這是正常現象。

故障現象	可能原因	解決方法
雪櫃不運行	溫度旋鈕指向“0”	轉動旋鈕至設定溫度檔次，啟動製冷功能
	未插上電源插頭，或插頭鬆動	插好電源插頭
	保險絲斷開或有故障	檢查保險絲，如有必要請更換
	插座出現故障	聯絡專業電工進行維修
食品不夠凍	溫度調節不當	參閱說明書相關部分
	雪櫃門處於長時間打開狀態	只在必要時打開雪櫃門
	24小時內放入太多溫熱食品	將溫度旋鈕暫時調向更高的檔位
	雪櫃附近有熱源	請參閱安裝位置的指示
雪櫃太凍	溫度檔位設定太高	將溫度旋鈕暫時調向較低的檔位
嘈音	雪櫃未水平放置好	調整支撐腳
	雪櫃貼著牆壁或其他物體	稍微移動雪櫃的位置
	雪櫃部件，如背部的管道接觸到其他部件或者牆壁	如有需要請小心整理部件

### ⚠ 警告！

如無法順利排除故障，請與客戶服務及維修中心聯絡，嚴禁非合資格人員對本機拆卸。

## 技術規格

型號	REF-195-S
功率	90 W
電壓／頻率	220-240 V ~ 50 Hz
燈膽	1 W
雪種	R600a (26g)
額定總容量	92 L
淨容量	90 L
產品尺寸	(H) 850 (W) 475 (D) 445 mm
淨重	19.5 kg

- 產品規格及設計如有變更，恕不另行通知。
- 中英文版本如有出入，一概以英文版為準。
- 本產品使用說明書以www.germanpool.com網上版為最新版本。

## 保用條款

此保用提供德國寶產品之機件在正常使用下壹年保用（自購買日起計算）。

- \* 貴戶須在購機十天內，以下列其中一種方式向本公司登記資料，保用手續方正式生效：

- 1) 填妥德國寶VIP手機應用程式保用登記表（掃描右方二維碼）
- 2) 填妥本公司網頁保用登記表  
[www.germanpool.com/warranty](http://www.germanpool.com/warranty)
- 3) 填妥保用卡郵寄至本公司。



## Warranty Terms & Conditions

Under normal operations, the product will guarantee a 1-year full warranty provided by German Pool (effective from the date of purchase).

- \* This warranty is not valid until customer registration information is received by our Service Centre within 10 days of purchase via one of the following means:

- 1) Visit our VIP App and register online: (Scan the QR Code on the right)
- 2) Visit our website and register online: [www.germanpool.com/warranty](http://www.germanpool.com/warranty)
- 3) Complete the attached Warranty Card and mail it back to our Customer Service Centre.



另請填妥以下表格並與正本發票一併保存，以便維修時核對資料。用戶提供之所有資料必須正確無誤，否則免費保用將會無效。Please fill out the form below. This information and the original purchase invoice will be required for any repairs. Warranty will be invalidated if information provided is found to be inaccurate.

型號 Model No. : REF-195-S

機身號碼 Serial No. : \_\_\_\_\_ 發票號碼 Invoice No. : \_\_\_\_\_

購買商號 Purchased From : \_\_\_\_\_ 購買日期 Purchase Date : \_\_\_\_\_

1. 未能出示購買發票正本者，將不獲免費維修服務。
  2. 用戶應依照說明書的指示操作。本保用並不包括：
    - 上門安裝、檢驗、維修或更換零件之人工以及一切運輸費用；
    - 因天然與人為意外造成的損壞（包括運輸及其他）；
    - 電源接合不當、不依說明書而錯誤或疏忽使用本機所引致之損壞。
  3. 於下列情況下，用戶之保用資格將被取消：
    - 購買發票有任何非認可之刪改；
    - 產品被用作商業或工業用途；
    - 產品經非認可之技術人員改裝或加裝任何配件；
    - 機身編號被擅自塗改、破壞或刪除。
  4. 總代理有權選擇維修或更換配件或其損壞部份。
  5. 產品一經被轉讓，其保用即被視作無效。
1. Customer who fails to present original purchase invoice will not be eligible for free warranty service.
  2. Customer should always follow the operating instructions. This warranty does not apply to:
    - labour costs for on-site installation, check-up, repair, replacement of parts and other transportation costs;
    - damages caused by accidents of any kind (including material transfer and others);
    - operating failures resulting from applying incorrect voltage, improper usage, and unauthorized installations or repairs.
  3. This warranty is invalid if:
    - the purchase invoice is modified by an unauthorized party;
    - the product is used for any commercial or industrial purposes;
    - the product is repaired or modified by unauthorized personnel, or unauthorized parts are installed;
    - the serial number is modified, damaged or removed from the product.
  4. German Pool will, at its discretion, repair or replace any defective part.
  5. This warranty will be void if there is any transfer of ownership from the original purchaser.

## 客戶服務及維修中心

### 中國香港

九龍大業街59號

三湘九龍灣貨運中心地下B室

電話：+852 2773 2888

傳真：+852 2356 9798

電郵：repairs@germanpool.com

### 中國澳門

澳門青洲大馬路(青洲新路)

515號美居廣場第二期1樓A座

電話：+853 2875 2699

傳真：+853 2875 2661

## Customer Service & Repair Centre

### Hong Kong, China

Unit B, G/F, Sunshine Kowloon Bay

Cargo Centre, 59 Tai Yip Street,

Kowloon, Hong Kong

Tel : +852 2773 2888

Fax : +852 2356 9798

Email : repairs@germanpool.com

### Macau, China

A, 1 Andar, Mei Kui Kuong Cheong Fase 2,

No.515 Avenida Do Conselheiro Borja

Macau

Tel : +853 2875 2699

Fax : +853 2875 2661

此保用只適用於香港及澳門 | This warranty is valid only in Hong Kong and Macau



## German Pool (Hong Kong) Limited

### Hong Kong, China

Room 113, Newport Centre Phase II, 116 Ma Tau  
Kok Road, Tokwawan, Kowloon, Hong Kong.  
Tel: +852 2773 2888  
Fax: +852 2765 8215

### Mainland China

8th, Xinxiang Road, Wusha Industrial Park,  
Daliang, Shunde, Foshan, Guangdong  
Tel: +86 757 2219 6888  
Fax: +86 757 2219 6809

### Macau, China

A, 1 Andar, Mei Kui Kuong Cheong Fase 2,  
No.515 Avenida Do Conselheiro Borja, Macau  
Tel: +853 2875 2699  
Fax: +853 2875 2661



香港 (S MARK)  
安全認證



中國輕電器/家電行業  
十大影響力品牌

CEO

CEO非凡品牌大賞



香港優質商標



香港工商業獎



2007  
最具潛質  
創星品牌企業獎



香港中小企業  
最佳拍檔大獎



香港消費者推祟品牌



香港《心嚮》  
優質服務證書



香港名牌十年成就獎  
HONG KONG TOP BRAND TEN YEAR  
ACHIEVEMENT AWARD

© All rights reserved. Copying, reproducing or using the contents of this manual is not allowed without prior authorization from German Pool, violators will be prosecuted.