

通用窗戶密封布套安裝說明

Universal Window Fabric Sealer Installation Instructions

Suitable for windows and doors
適用於門窗

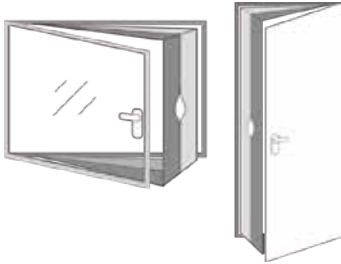

One Fabric Sealer with Zipper
One Roll of Velcro Adhesive Tape
一塊拉鏈布套
一卷「魔術貼」膠帶



1. 打開並清潔門窗及框架。

1. Open window/door and clean the frames
before sticking on the velcro tape.

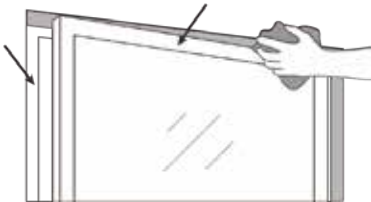

2. 根據門窗尺寸裁剪魔術貼，撕下膠紙保護貼，然後貼在窗/門框上。重覆步驟，將魔術貼貼在窗/門（向室內）的邊框。

2. Cut the velcro tape according to the size
of the window/door, remove the backing paper
and fix the tape onto the frame, then do the
same on the inner surface of the window
(on the handle side).

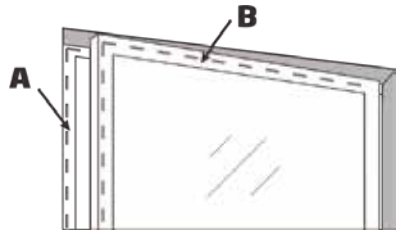

3. Stick the wider side (A) of the fabric sealer onto the window/door frame, and the narrower side (B) onto the window/door (handle side) starting from the centre then upwards and downwards.

3. 將布套拉鏈向內，拉鏈兩側較寬的一面 (A) 貼在窗框上，然後將較窄的一面 (B) 從中心位置開始依次向上及向下貼在窗門上。

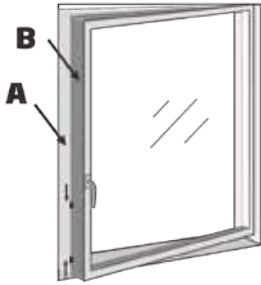

4. Close the window/door, and make sure the fabric and velcro strip are not stuck in the closing seams, and the window/door can close all the way. Tidily fold up any spare fabric.

4. 關閉窗戶，確保布套不會卡住窗戶密封處，並檢查窗戶是否能在貼上膠帶後完全關閉。然後將多餘的布料摺疊整齊。

5. Open the zipper of the fabric sealer (at the bottom or middle of the window/door) and insert the exhaust hose into the opening. Readjust the zipper so that the exhaust hose is securely attached and there is no air exchange between the inside and the outside.

5. 在布套拉鏈處（窗戶底部或中部）打開拉鏈，然後將排氣管插入拉鏈孔內。調整拉鏈，固定排氣管，確保拉鏈與排氣管連接處盡量密封，沒有縫隙。

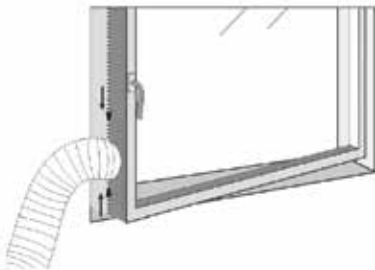

6. Universal Window Fabric Sealer installation is complete.

6. 窗戶密封布套安裝完成。

Note:

Make sure the fabric sealer is not stuck in the closing seals. When air conditioner is turned off, simply remove the exhaust hose and close the window/door.

注意：

請檢查布料不會卡住窗戶密封處。關閉空調後只需移除排氣管並關上窗戶即可。

