

GERMAN POOL 德國寶

超薄數碼恆溫氣體熱水器
Instantaneous Gas Water Heater

GPS16



即時網上登記保用
Online Warranty Registration



在使用之前請詳細閱讀「使用說明書」及「保用條款」，並妥為保存。
Please read these instructions and warranty information carefully before use and keep them handy for future reference.



使用說明書 USER MANUAL

適用於香港

根據香港法例第51章（氣體安全氣體裝置技工及氣體工程承辦商註冊）規例規定，任何人如非註冊氣體裝置技工而安裝/接駁或修理這件氣體爐具即屬違法。請直接或經同你的氣體供應商安排由註冊氣體工程承辦商作出安全的安裝及維修。

For Use in Hong Kong

It is an offence under the Gas Safety (Registration of Gas Installers and Gas Contractors) Regulations, Cap.51, for any person who is not a registered gas installer to install/connect this gas appliance, or to carry out repairs. Contact a registered gas contractor, directly or through your gas supplier, to arrange for safe installation and servicing.

內容 Content

請確定遵從 Please make sure to follow

- 安全操作注意事項 2
Cautions for safety operations

如何操作 How to Operate

- 各部份名稱 9
Parts identifications
- 第一次使用熱水器 10
To operate the heater for the first time
- 使用熱水器方法 11
Operating Instructions
- 日常檢查及保養 13
Daily inspection and maintenance

當有需要時請查看 Please read when necessary



- 熱水器修理指南 15
Trouble shooting of the heater
- 規格 17
Specifications
- 維修服務 18
Repair service

安全操作注意事項 Cautions for safety operations



請確定遵從。
Please make sure to follow.

為防止使用者或他人受傷害及財物受到破壞，下列項目必須遵從。
The below listed items shall be strictly followed to prevent the user and other people from suffering an injury and to prevent your property from being damaged.

- 當不遵從“注意事項”而發生意外，以下標誌表示受傷害及破壞之程度。
The below markings show the level of injury and damage caused when the cautions are not followed.

 危險 DANGER	項目有此標誌表示將會有生命危險及嚴重受傷。 This marking is labeled on those items that any death or a serious injury is approaching.
 警告 WARNING	項目有此標誌表示可能會有生命危險及嚴重受傷。 This marking is labeled on those items that any death or a serious injury is expected.
 注意 CAUTIONS	項目有此標誌表示可能會有受傷及財物受到破壞。 This marking is labeled on those items that any injury and material damage is expected.

- 以下標誌會用於此使用說明書。
The below listed markings are used in the operation manual.

	此標誌表示需提高警覺。 This marking is given to those items to call your attention.
	此標誌給禁止項目使用。 This marking is given to those items banned.
	此標誌代表這些項目必須確實遵從。 This marking is given to those items to be strictly followed.

安全操作注意事項

Cautions for safety operations

請確定遵從。
Please make sure to follow.

危險 DANGER

氣體洩漏注意事項 Cautions when gas leaks

■ 當發現氣體洩漏時，關掉主氣體閥門，打開所有窗戶及通知氣體代理商或油公司。

When the gas leakage is detected, close main gas valve, open the windows and doors and call your dealer or gas company.

❗ 關掉主氣體閥門
Close main gas valve.

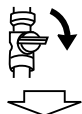

盡量打開所有窗戶。
Open windows and doors fully.



通知氣體代理商或油公司。
Call your dealer or gas company.



氣體洩漏可引致火警或爆炸。
Gas leakage may cause a fire or an explosion.

切勿開啟或關閉任何電掣或點火。
Do not turn on/off the electrical switches or ignite fire.



熄滅所有火源
No fire



可能引致火警或爆炸。
A fire or an explosion may be caused.

安裝注意事項 Cautions for installations

切勿使用拆除煙道或煙道被堵塞之熱水器。
Do not use the heater when the flue duct is removed or clogged.

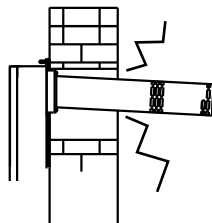

使用已拆除煙道或煙道被堵塞之熱水器，廢氣會進入室內及熱水器不正常燃燒而可能產生有毒一氧化碳或缺氧。
When the flue duct is removed or clogged, the exhaust air leaks into the room and the abnormal combustion of the heater may be caused. A carbon monoxide or an oxygen depletion may be caused.

切勿將熱水器安裝於室外。
Do not install the heater outdoors.

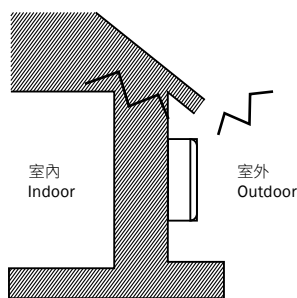

不正常燃燒可能導致生火或熱水器被雨水破壞。
A fire may be caused by an abnormal combustion or the heater may be damaged by the rain.

警告 WARNING

■ 不正常燃燒可從氣味及聲音偵察或當火警/地震發生時，請確定遵照下列程式。

When an abnormal combustion, smell and sound is detected or when a fire or an earthquake takes place, make sure to follow the below procedures.

❗ 關掉熱水掣。
Close hot water tap.

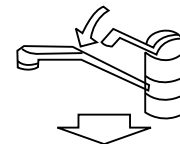

關掉熱水器主開關。
Turn off the main switch of the heater.

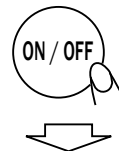

關掉氣體及供水閥門。
Close main gas valve and main water valve.

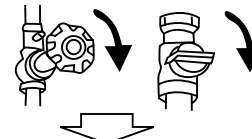

通知氣體代理商或油公司。
Call your dealer or gas company.



若不正常現象持續，可能導致生火。
If the abnormal condition is kept unchanged, a fire may be caused.

當熱水器長期不使用，請確定關掉熱水器之主開關及關掉主氣體閥門。

Make sure to turn off the main switch of the heater and to close the main gas valve when the heater is not used for a long time.

❗ 當熱水器長期不使用，為避免熱水器內的水結冰，建議排放熱水器內之水。
If the heater is not used for a long time, it is suggested to drain out the water inside the heater to prevent freezing.

氣體洩漏可能引致生火。
A gas leakage may cause a fire.

❗ 切勿使用非附貼於熱水器上所標明之氣體及電力供應。
Do not use gas and power supply other than specified in the specifications label attached on the heater.

若使用其他氣體及電力供應，可能導致生火或不正常燃燒而產生有毒一氧化碳。
If a different gas or power supply is used, a fire or a carbon monoxide toxication may be caused by an abnormal combustion of the heater.

❗ 熱水器與易燃物品保持距離。
Keep the inflammables away from the heater.

熱水器頂：超過300毫米
Up: more than 300mm
熱水器旁：超過45毫米
Side: more than 45mm
熱水器前面：超過600毫米
Front: more than 600mm

若熱水器與易燃物品不能保持最低限度距離，可能會引致生火。
If the minimum distance from the inflammable is not kept, the fire may be caused.

安全操作注意事項

Cautions for safety operations

請確定遵從。
Please make sure to follow.

警告 WARNING

使用熱水注意事項 Cautions for using hot water

- 使用花灑沐浴前，請先用手測試熱水溫度。

Make sure to check hot water temperature by hand before taking a shower.



小心被熱水燙傷。

Caution: Prevent from getting burnt.

可能被熱水燙傷。 You may be scalded by the hot water.

- 若使用混合式水龍頭，請先關掉熱水掣。



熱水掣關掉後，熱水管內仍存著熱水。下次使用時，熱水管內熱水可能令你燙傷。 If a water tap is closed first, hot water will remain in the water piping system. You may get burnt by the hot water remained in the piping system in your next use.

- 若使用混合式水龍頭，切記將冷熱水選擇杆推回原來位置。

When a mixing tap is used, make sure to return the change over lever to the original position.



若冷熱水選擇杆置於半開位置時，你可能會被熱水燙傷。 You may get burnt by hot water if the lever is positioned in the half way.

- 切勿在熱水器附近使用易燃物品，如汽油、苯。



可能引致生火。 A fire may be caused.

- 當使用熱水時，除使用者外，切勿讓其他人調校熱水溫度。

When hot water is used, make sure that hot water temperature will not be changed by persons other than user.



使用熱水器途中改變熱水溫度，有可能被熱水燙傷，若熱水器使用途中被關掉，有可能導致受傷。

If the hot water temperature is changed in the middle of the use, you may get burnt. If the heater is turned off in the middle of the use, you may have the risk to be injured.

- 當使用混合式水龍頭而同一個熱水系統之另一個熱水龍頭開啟時，你可能會被燙傷。

When the mixing tap is used, there may be a case that you will get burnt if the other hot water tap in the same hot water piping system is opened.



小心被熱水燙傷。

Caution: Prevent from getting burnt.

熱水供應可能隨時到達，請先用手測試後才使用。 Hot water may be supplied suddenly. Make sure to wait for a while and to check hot water temperature by hand before use.

- 切勿為熱水器安裝檔口。

Do not install a covering around the heater.

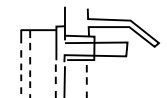

不正常燃燒可能導致生火或產生問題。 A fire or trouble of the heater may be caused by an abnormal combustion.

警告 WARNING

- 緊固地插入。

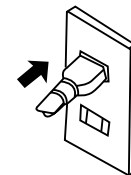

如未緊固插好，熱水器可能有問題。 If not plugged properly, the heater may be malfunctioned.

- 間中清潔電源插的塵埃。



若電源插積聚塵埃，潮濕導致絕緣降低而可能引致生火。 If any dust gathered on the plug, the electrical insulation becomes poor due to humidity and may cause a fire.

- 切勿破壞電源線及電源插。



若使用損壞的電線及電源插，可能導致觸電，短路及生火。 If damaged cord or plug is used, electric shock, short-circuit and a fire may be caused.

- 確定電路不超載。



若超載，可能生熱而導致生火。 If overloaded, it may generate heat to cause a fire.

- 手濕切勿觸摸電插頭。



可能導致觸電。 An electrical shock may be caused.

- 當插入或拔出電源，確定拿緊電插頭。



若拔出或拉出電源線，電源線可能脫離而導致生火或觸電。 If you plug out by pulling the power cord, power cord may be disconnected to cause a fire or an electric shock.

- 熱水器之安裝或搬移，必須由註冊氣體技工進行。



若使用不正確安裝或搬遷的熱水器，損壞的電源線及電源插，可能導致觸電，短路及生火。 If the heater is not installed properly, electric shock, short-circuit or a fire or a trouble may be caused.

安全操作注意事項

Cautions for safety operations

請確定遵從。
Please make sure to follow.

注意 CAUTIONS

- 熱水器只供淋浴或沐浴使用，切勿作其他用途。
Do not use the heater for purposes other than supplying hot water for bath and shower.



若熱水器作其他用途，可能產生問題或導致生火。
If the heater is used for other purpose, a fire or a trouble of the heater may be caused.

- 熱水器操作中或剛停止操作時，切勿觸摸熱水器煙道。
Do not touch a flue duct during operation or right after the heater is turned off.



切勿觸摸。
Do not touch.

你可能被燙傷。
You may get burnt.

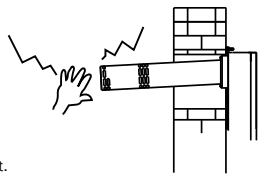

- 切勿用熱水器攀爬或將物件放置於熱水器上。
Do not ride on the heater or place anything on the heater.



你可能被燙傷或受傷及熱水器可能被破壞。
You may get burnt or injured and the heater may be damaged.

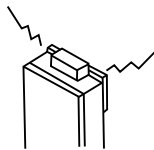

- 切勿將熱水器安裝在車輛或船上。
Do not install the heater on a vehicle or a vessel.



熱水器可能倒下而導致生火或令人受傷。
The heater may fall down to cause a fire or an injury.

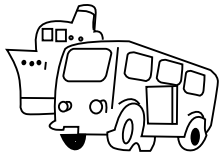

- 檢查及維修熱水器之前，確定切斷電源，關掉氣體及水閥門及熱水器已冷卻。
Make sure to close main gas and water valves, to plug out the heater and to confirm the heater is cooled down before inspection and maintenance.



熱水器可能產生問題或燒掉。
A burnt and a trouble of the heater may be caused.

- 確定熱水器已接地。
Make sure to confirm that the heater is grounded.



若沒有安裝接地線，漏電時可能導致觸電。
If not grounded, an electric shock may be caused by an electric leakage.

- 切勿改裝熱水器。
Do not modify the heater.



切勿拆散。
Do not disassemble.

熱水器可能產生問題。
The heater may have problems.

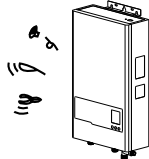

- 切勿使用熱水器內之水作食水或煮食之用。
Do not drink water kept in the heater nor use it for cooking.



可能影響健康。
Your health may be damaged.

- 當電力發生故障時，關掉熱水掣。
Close hot water tap at the time of power failure.

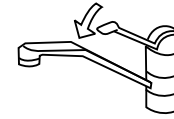

熱水器操作時遇電力故障，會停止燃燒及熱水會漸漸冷下來。
When the power failure takes place during operation, the combustion stops and hot water becomes cold.

- 遇供水停止時，關掉主開關及熱水掣。
Turn off the main switch and close the hot water tap at the time of water suspension.

若不視察，熱水器可能損壞。
The heater may be damaged.

- 若夏天時來水溫度較高，增加水流量。
If the lukewarm water cannot be supplied during summer, increase the water volume.

熱水供應時減少水流量，有時會引致熱水溫度很高。
When the hot water is supplied, there may be a case that hot water temperature becomes very hot by decreasing water volume.

- 使用後關掉主開關。
Turn off the main switch after use.

若不關掉，小孩玩耍時可能開啟熱水器。
If not turned off, the heater may operate when being played by children.

- 切勿使用非指定之元件及配件。
Do not use other optional components and accessories than specified.

熱水器可能會出現問題。
A trouble of the heater may be caused.

- 若使用混合式龍頭，間中讓水流動。
When a mixing tap is used, sometimes let water flow.

若長期沒有開水，放出來的水可能渾濁。
There may be a case that the cloudy water comes out if the supply water does not flow for a long time.

- 熱水器操作時，切勿切斷電源。
Do not unplug during operation.

熱水器可能損壞。
The heater may be damaged.

- 熱水器需安裝於遠離電視機及收音機之地方。
Install the heater away from TVs and radios.

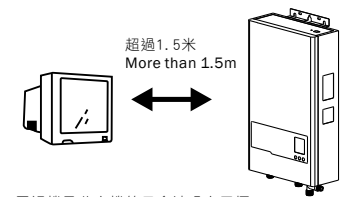

電視機及收音機節目會被噪音干擾。
TV or radio program may be hampered by noises.

各部份名稱

Parts identifications

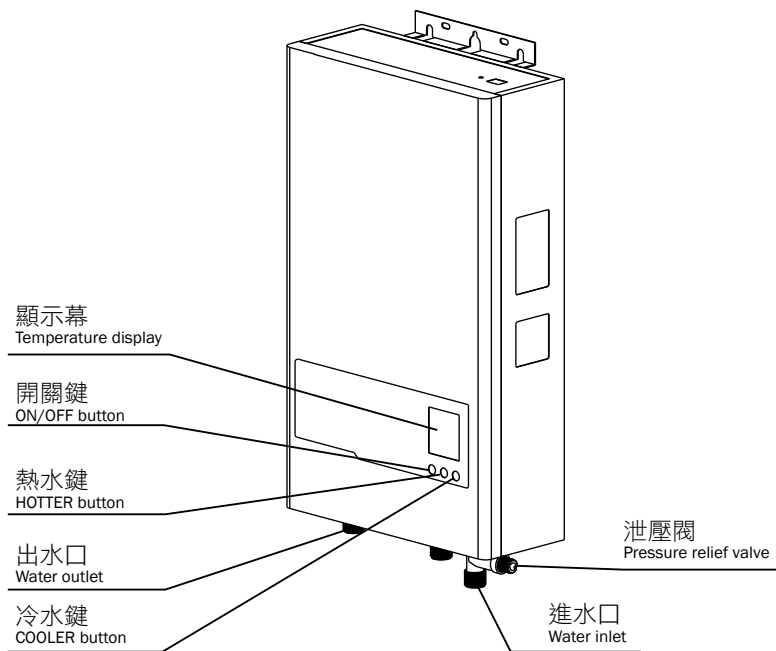

熱水爐最大熱負荷檢測方法

因GPS16恒溫式燃氣快速熱水爐是自動調節燃氣流量、水流量以達到自動恒溫的效果，所以，在檢測時，其負荷可能達不到最大熱負荷。

檢測最大熱負荷的方法：按“開/關”鍵，關機，自動調水閥自動重定至最大水流量狀態。打開面殼，拔除自動調水閥接外掛程式，使其停止工作。然後蓋上面板，按恒溫機檢測方法檢測最大熱負荷。

Water heater maximum heat load measurement method

Thermostat type gas instantaneous hot water heaters in this series are auto-regulating gas flow, effect of water flow to achieve automatic thermostat. So, at the time of testing, the load may fall short of the maximum heat load.

Methods for detection of maximum heat load:

Press the on/off switch, shutdown, automatic water valve automatically reset to the maximum water flow condition. Open the panel, removal of auto-valve connectors, make it stop working. Then close the Panel. Constant temperature detection method for detection of maximum heat load.

第一次使用熱水器

To operate the heater for the first time

以下解釋推桿拉起後熱水掣便開啟。
Hot water tap is opened when the lever is up, explanation as follows.

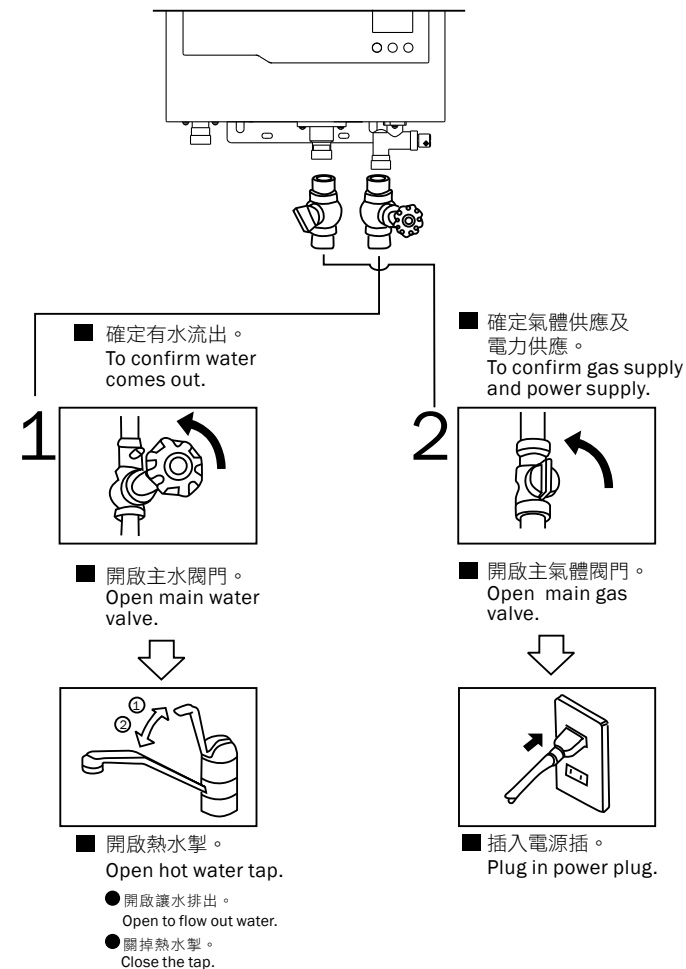

通電顯示幕中“GERMAN POOL”燈亮，開水時機器點火及風機轉動，顯示幕中的“ ”燈亮，機械正常工作。

When there is power supply, the lamp of "GERMAN POOL" at display will be on. Then turn on the water, and the heater ignition and the blower running will be started at same time, then the " " on display will be on.

使用熱水器方法

Operating Instructions

■ 調校合適熱水溫度

Set the desired hot water temperature

設置溫度調節，按“▲”或“△”按鍵，調整設置溫度經過十秒後，出水溫度逐步達到設置溫度。

Setting the water temperature by pressing "▲" or "△" button of the control panel, the water flow out will gradually reach the temperature you desired after 10 seconds.

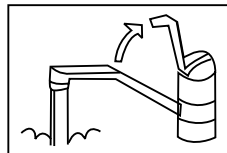
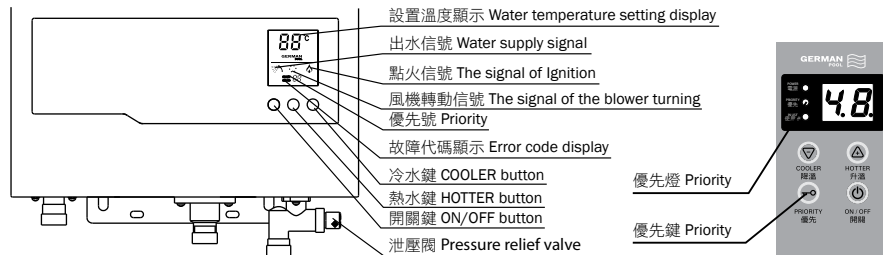

開啟熱水掣。
Open hot water tap.

(熱水器自動點火燃燒。)
(Water heater will ignite automatically.)

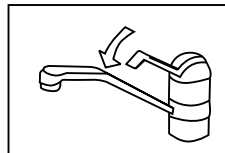

關掉熱水掣。
Close hot water tap.

(熱水器即時自動熄火。)
(Water heater will turn off the flame immediately.)

■ 帶線控器的使用方法

- 熱水器可選配最多兩個線控器，主控制器和線控器均能控制熱水器；
- 只有獲取優先的控制器，方可進行設置；
- 主控制器和線控器處於關機狀態時，熱水器亦會關掉，否則處於待機狀態；
- 主控制器具有記憶功能，可記憶最後獲取優先的設置溫度，如需改變，可獲取優先後重新設置；

優先的獲取

1. 未開機時，先啟動的控制器或線控器自動獲取優先；
2. 線控器未獲取優先或退出優先時，主控制器自動獲取優先；
3. 按線控器上的“優先”鍵可獲優先；當其中一個A線空氣獲取優先後，B線控器按“優先”鍵也不可獲取優先，只有A退出優先後方可獲取；主控制器優先時，其優先指示燈長亮，線控器優先指示燈不亮；
4. A線控器獲取優先時，優先指示燈會長亮，主控制器與另一B線控器優先指示燈閃亮；

如何退出“優先”

再按一次“優先”鍵，可退出優先，或連續15分鐘未使用，便會自動退出優先。

■ How to use the remote controller

- A heater could be connected with a main controller and two remote controllers at maximum. You can use either of the controllers to control the heater.
- Only the controller that gets the priority can control the heater.
- When both main controller and the remote controller(s) are in (OFF) status, the heater will be turned off; otherwise, the heater will be in stand-by mode.
- The main controller is installed with a memory function, which could store the last temperature setting. If you need to make any changes, you need to get it with the priority first and reset accordingly.

How to get the priority

1. When turning on the heater, the priority will be auto-assigned to the controller that is operated first.
2. When the remote controller exits the priority, the main controller will get the priority automatically.
3. When main controller gets the priority, its priority indicator will be on and the indicator on remote controller(s) will be off.
4. When pressing the priority key of any remote controller, it could get priority. But if remote controller A gets the priority, remote controller B cannot get the priority by press of the priority key until the A controller exits priority.
5. The priority indicator of remote controller A will be on when it gets the priority. At the same time, the priority indicator of main controller and remote controller B will be flashing.

How to exit priority

The priority will exit when pressing the priority key on the remote controller again or if it is not operation for 15 minutes.

日常檢查及保養

Regular inspection and maintenance

依照下列程式定期進行日常檢查及保養。
Carry out the daily inspection and maintenance regularly following the procedure described below.

保養前 Before maintenance

保養 Maintenance

預備工作 Preparations

注意 Cautions

關掉主氣體及冷熱水閥門，切斷電源供應及待熱水器冷卻。
Close main gas and water valves, plug out power supply and wait until the heater is cooled down.

- 1 關掉主開關。
Turn off the main switch.



- 2 關掉主氣體及冷熱水閥門。
Close main gas and water valves.

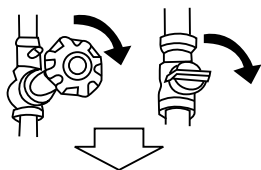

- 3 切斷電源。
Plug out power supply.



- 4 熱水器冷卻後，進行下列步驟。
Carry out the following after the heater is cooled down.

熱水器 Heater

用刷掃或毛巾加廚房清潔液揩抹熱水器。
Wipe the heater with swab or towel using a kitchen cleanser.

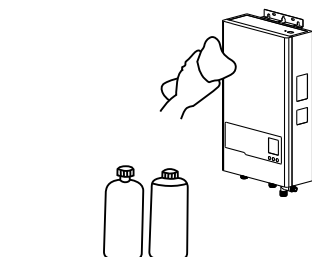

注意：切勿用苯或稀釋劑。
Note: Do not use benzen and thinner.

保養 Maintenance

檢查 Inspection

濾水器 Water filter

- 1 從泄壓閥拆除過濾網和磁鋼。
Disassemble filter and magnetic steel from the pressure relief valve.

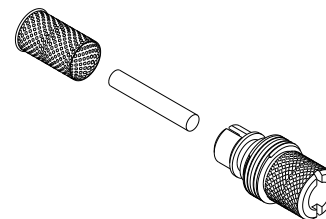

- 2 用牙刷清洗過濾網，用清水沖洗磁鋼。
Use toothbrush to clean the filter and clean water for magnetic steel.

- 3 安裝泄壓閥於入水口。
Install the pressure relief valve onto the water inlet.

- 是否有異常之操作聲音？
Any abnormal operation sound?

- 熱水器外表是否改變？
Any changes on the appearance of the heater?

- 熱水器周圍是否有易燃物品？
Any inflammables around the heater?

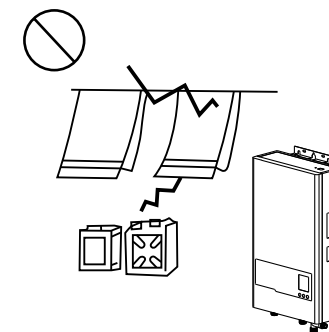

數碼恆溫熱水爐具有兩種排氣方式，頂排式和背排式，其內部結構及使用性能相同，供客戶選用。如上圖所示。

The water heaters have two types of gas exhaust methods, top flue and back flue, the structures and operations of the heater is the same for customers choice. As shown in the above drawings.

熱水器修理指南

Trouble shooting of the heater

若熱水器出現問題，依照下列程式檢查熱水器。
If there is any trouble on the heater, check the heater following the below listed procedures.

故障 Symptom	需要檢查的項目。 Items to check.
<p>停止操作 (燃燒) No operation (combustion)</p> 	<ul style="list-style-type: none"> • 電源插是否緊插？ Is power plug plugged in firmly? • 主氣體閥門是否全開？ Is main gas valve opened fully? • 主供水閥門是否全開？ Is main water valve opened fully? • 供水是否停止？ Is there a suspension of the water supply? • 是否電力供應故障？ Is there a power failure? • 管道系統內是否留有空氣？ Is there air left in the piping system? • 重覆燃點步驟。 Repeat ignition procedures. • 濾水器是否堵塞？(參照第12頁) Is water filter clogged?(Refer to page 12)
<p>水溫不夠。 Water is not warm enough.</p>	<ul style="list-style-type: none"> • 主氣體閥門是否全開？ Is main gas valve fully opened? • 冷熱水是否混和合適？ Are hot and cold water mixed properly? • 設置溫度是否過低？ Is the set temperature too low?
<p>水溫過高。 Hot water temperature is too high.</p>	<ul style="list-style-type: none"> • 主供水閥門是否全開？ Is main water valve opened fully? • 濾水器是否堵塞？(參照第12頁) Is water filter clogged?(Refer to page 12) • 設置溫度是否過高？ Is the set temperature too high?

下列的徵兆並非是產品缺點。
Below listed symptoms are not defects.

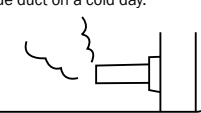
故障 Symptom	原因 Reason
<p>冬天時煙道出水蒸氣。 Steam comes out from a flue duct on a cold day.</p> 	<p>這不是不正常，只因廢氣內之水份轉為水蒸氣。 This is not abnormal. This happens when water in the exhaust air becomes vapor.</p>
<p>熱水供應停止後聽到風扇運轉聲音。 Fan rotating sound is heard after hot water supply is stopped.</p>	<p>風扇連續運轉約30秒鐘能令熱水器迅速冷卻和排掉熱水器內殘留的廢氣。 When the blower constantly running 30 seconds more, then the heater will be cooling down and the exhaust air inside the heater will be exhausted.</p>
<p>熱水掣輕微關閉時熱水會渾濁。 Hot water becomes cloudy when hot water tap is closed slightly.</p>	<p>由於空氣在水裡變為水泡。 It is only because air in the water becomes bubbles.</p>
<p>突然關閉熱水掣會產生震盪聲。 Bumpy noise is heard when hot water tap is closed suddenly.</p>	<p>突然停止供水通常會聽到這類聲音。 This sound is normally heard when water supply is stopped suddenly.</p>
<p>熱水掣輕微關閉時，燃燒停止及熱水漸漸轉冷。 When hot water tap is closed slightly, the combustion stops and hot water becomes cold.</p>	<p>當供水壓力低於熱水器最低點火壓力，熱水器將停止操作。 When the water pressure becomes lower than the minimum ignition water pressure, the heater will be turned off.</p>

若熱水器出現問題，安全裝置會啟動。

Safety devices will be activated when something is wrong with the heater.

1. 操作時火焰熄滅 Flame on the burner turned off during operation	----- 熄火安全裝置 Flame failure device
2. 熱水器異常高溫 Heater become abnormally hot	----- 防止過熱裝置 Overheat prevention device
3. 無供水下燃燒 Combustion without water supply	----- 防止空燒安全裝置 Empty combustion prevention device
4. 超電流量 Excess electric flow	----- 電流保險絲 Electric fuse
5. 不正常高水壓 Abnormally high water pressure	----- 超壓排洩閥 Pressure relief valve

故障代碼 Error Code

E0 出水探頭故障	Outlet Water Detector Failure	E4 進水探頭故障	Inlet Water Detector Failure
E1 點火失敗或意外熄火	Ignition Failure	E5 風機故障	Fan Failure
E2 偽火故障	False Fire Failure	E6 超溫保護	Overheat Protection
E3 溫控器故障	Temperature Controller Failure	E7 電磁閥開路故障	Breakage Fault of Solenoid Valve

若以上五個裝置之中其中有一個啟動，關掉主氣體及水閥門及通知代理商。
If one of above 1~5 devices is activated, close main gas and water valves and call the dealer.

規格 Specifications

產品 Product		超薄數碼恒溫氣體熱水器 Instantaneous Gas Water Heater	
型號 Model number		GPS16-LG-U GPS16-LG-B 石油氣 LP Gas	GPS16-TG-U GPS16-TG-B 煤氣 TG
系統 System	熱水供應 Hot water supply	多點式 Multi-points	
	安裝及煙道 Installation & Flue	室內/強制對衡式 Indoor/Forced balanced flue system	
點火 Ignition		電子連續點火 Electric continuous spark ignition	
水壓 Water pressure	操作水壓 Operation water pressure	0.02-0.8MPa(0.2-8kgf/cm ²)	
	點火水壓 Ignition water pressure	0.02MPa(0.2kgf/cm ²)	
機身尺寸 Product Dimensions	熱水器 heater	高x寬x深 / H x W x D 550mmX345mmX138mm	
重量 Weight	熱水器 heater	14公斤(kg)	
喉管接駁 Pipe connection	氣體 gas	3/4喉牙 R3/4(PT3/4)	
	冷水 water	半寸(1/2)喉牙 R1/2(PT1/2)	
	熱水 hot water	半寸(1/2)喉牙 R1/2(PT1/2)	
電力供應 Power supply		AC220V (50Hz)	
電源 Electric	耗電量 Consumption	石油氣 LP Gas 最大火力 at maximum combustion: 48W 煤氣 TG 最大火力 at maximum combustion: 33W	
	控制方式 Control method		水控後制式 Water outlet control
安全裝置 Safety devices		熄火安全裝置、防止過熱裝置、防止空燒安全裝置、電流保險絲、超壓排洩閥 Flame failure device, Overheat prevention device, Empty combustion prevention device, Electric fuse, Pressure relief valve	
配件 Accessory		使用說明書, 安裝說明書, 螺絲 Operation manual, Installation manual, Screws	
適用氣體 Gas type		石油氣 LPG	煤氣 (香港) Town Gas(HK)
耗氣量 Gas Consumption	最大 Maximum	122.4MJ/h (34 kW)	122.4MJ/h (34 kW)
	最小 Minimum	25.2MJ/h (7 kW)	25.2MJ/h (7 kW)
出水量 (公升/分鐘) Hot water supply (L/min)	最多溫升 25°C Maximum temperature increase 25°C	16	16
	最少溫升 25°C Minimum temperature increase 25°C	3.0	3.0
	最多溫升 40°C Maximum temperature increase 40°C	10	10

產品規格及設計如有變更, 恕不另行通知。
中英文版本如有出入, 一概以中文版為準。
本產品使用說明書以 www.germanpool.com 網上版為最新版本。

Specifications are subject to change without prior notice.
If there is any inconsistency or ambiguity between the English version and the Chinese version, the Chinese version shall prevail.
Refer to www.germanpool.com for the most up-to-date version of the Operating Instructions.

請填妥以下空格並與發票一併保存, 以便維修時核對資料。用戶提供本公司之所有資料必須正確無誤, 否則免費保用將會無效。
Please fill out the form below. This information and the purchase invoice will be required for any repairs. Warranty will be invalid if information provided is found to be inaccurate.

型號 Model No. : GPS16

機身號碼 Serial No. : _____

購買商號 Purchased From : _____

發票號碼 Invoice No. : _____

購買日期 Purchase Date : _____

保用條款

此保用提供德國寶產品之機件在正常使用下五年零件保用 (塑膠件除外) 及首年上門檢查、更換零件之人工、運輸及裝拆服務 (任何搭棚相關費用除外)。保用年期自購買日起計算。

* 貴戶須在購機十天內, 以下列其中一種方式向本公司登記資料, 保用手續方正式生效:

- 1) 填妥本公司網頁內之保用登記表格
www.germanpool.com/warranty
- 2) 填妥保用登記卡, 並連同購機發票之副本一併郵寄到客戶服務總部 (本公司將不發還發票副本或登記卡)。

1. 未能出示購買發票正本者, 將不獲免費維修服務。
2. 用戶應依照說明書的指示操作。本保用並不包括:
 - 任何附件及輔助裝置;
 - 因天然與人為意外造成的損壞 (包括運輸及其它);
 - 電源接合不當、不依說明書而錯誤或疏忽使用本機所引致之損壞。
3. 於下列情況下, 用戶之保用資格將被取消:
 - 購買發票有任何非認可之刪改;
 - 產品被用作商業或工業用途;
 - 產品經非認可之技術人員改裝或加裝任何配件;
 - 機身編號被擅自塗改、破壞或刪除。
4. 如用戶自攜熱水器或部份配件到本公司維修部檢查或維修, 本公司將會收取檢查或測試費用。
5. 總代理有權選擇維修或更換配件或其損壞部份。
6. 產品一經被轉讓, 其保用即被視作無效。
7. 保用只在香港、九龍及新界區有效, 東涌、愉景灣及離島須額外收取交通費用。

客戶服務及維修中心

中國香港

九龍灣啟興道1-3號九龍貨倉10樓

電話: +852 2333 6249

傳真: +852 2356 9798

電郵: repairs@germanpool.com

Warranty Terms & Conditions

Under normal operations, the water heater will receive a five years full warranty (except plastic parts), first year service fee for testing, labour transportation and installation (excluding any scaffolding costs) provided by German Pool (effective starting from the date of purchase).

This warranty is not valid until Customer's registration information is returned to and received by our Service Centre within 10 days of purchase via one of the following methods:

- 1) Visit our website and register online:
www.germanpool.com/warranty
- 2) Complete all fields on the attached Warranty Card and mail it back to our Customer Service Headquarters along with a photocopy of the purchase invoice (Warranty Card and invoice copy will not be returned to Customer).

1. Customer who fails to present original purchase invoice will be disqualified for free warranty.
2. Customer should always follow the operating instructions. This warranty does not apply to:
 - any accessories and auxiliary devices;
 - damages caused by accidents of any kind (including transport and others);
 - operating failures resulted by incorrect voltage, improper operations and unauthorized installations or repairs.
3. This warranty is invalid if:
 - purchase invoice is modified by unauthorized party;
 - product is used for any commercial or industrial applications;
 - product is repaired or modified by unauthorized personnel, or unauthorized parts are installed;
 - serial number is modified, damaged or removed from the product.
4. Regardless of warranty status, all walk-in requests for water heater repair or replacement service at our Customer Service Centre are subject to testing and handling charges.
5. German Pool will, in its discretion, repair or replace any defective part.
6. This warranty will be void if there is any transfer of ownership from the original purchaser.
7. Service area includes Hong Kong Island, Kowloon and New Territories. Repairs in Tung Chung, Discovery Bay or other outlying islands are subject to extra service charges.

Customer Service & Repair Centre

Hong Kong, China

10/F, Kowloon Godown, 1-3 Kai Hing Road, Kowloon Bay,

Kowloon, Hong Kong

Tel : +852 2333 6249

Fax : +852 2356 9798

Email : repairs@germanpool.com

GERMAN
POOL



德國寶

德國寶 (香港) 有限公司 German Pool (Hong Kong) Limited

中國香港 Hong Kong, China

香港九龍土瓜灣馬頭角道116號
新寶工商中心2期113號室
Room 113, Newport Centre Phase II, 116 Ma Tau
Kok Road, Tokwawan, Kowloon, Hong Kong.
電話 Tel: +852 2773 2888
傳真 Fax: +852 2765 8215

中國內地 Mainland China

廣東省佛山市順德區
大良南國東路德順廣場三層
3/F, Takshun Plaza, Nanguo East Road,
Shunde, Foshan, Guangdong
電話 Tel: +86 757 2980 8308
傳真 Fax: +86 757 2980 8318

中國澳門 Macau, China

澳門俾利喇街145號
寶豐工業大廈3樓
3/F, Edificio Industrial Pou Fung,
145 Rua de Francisco Xavier Pereira, Macau
電話 Tel: +853 2875 2699
傳真 Fax: +853 2875 2661



香港名牌十年成就獎
HONG KONG TOP BRAND TEN YEAR
ACHIEVEMENT AWARD



香港註冊名牌
HONG KONG
PREMIER BRAND



2007
CERTIFICATE AWARD FOR THE BEST BRAND ENTERPRISE
註冊最佳企業獎



中小企業
最佳拍檔大獎



© 版權所有。未獲德國寶授權，不得翻印、複製或使用本說明書作任何商業用途，違者必究。

© All rights reserved. Copying, reproducing or using the contents of this manual is not allowed without prior authorization from German Pool, violators will be prosecuted.

www.germanpool.com